

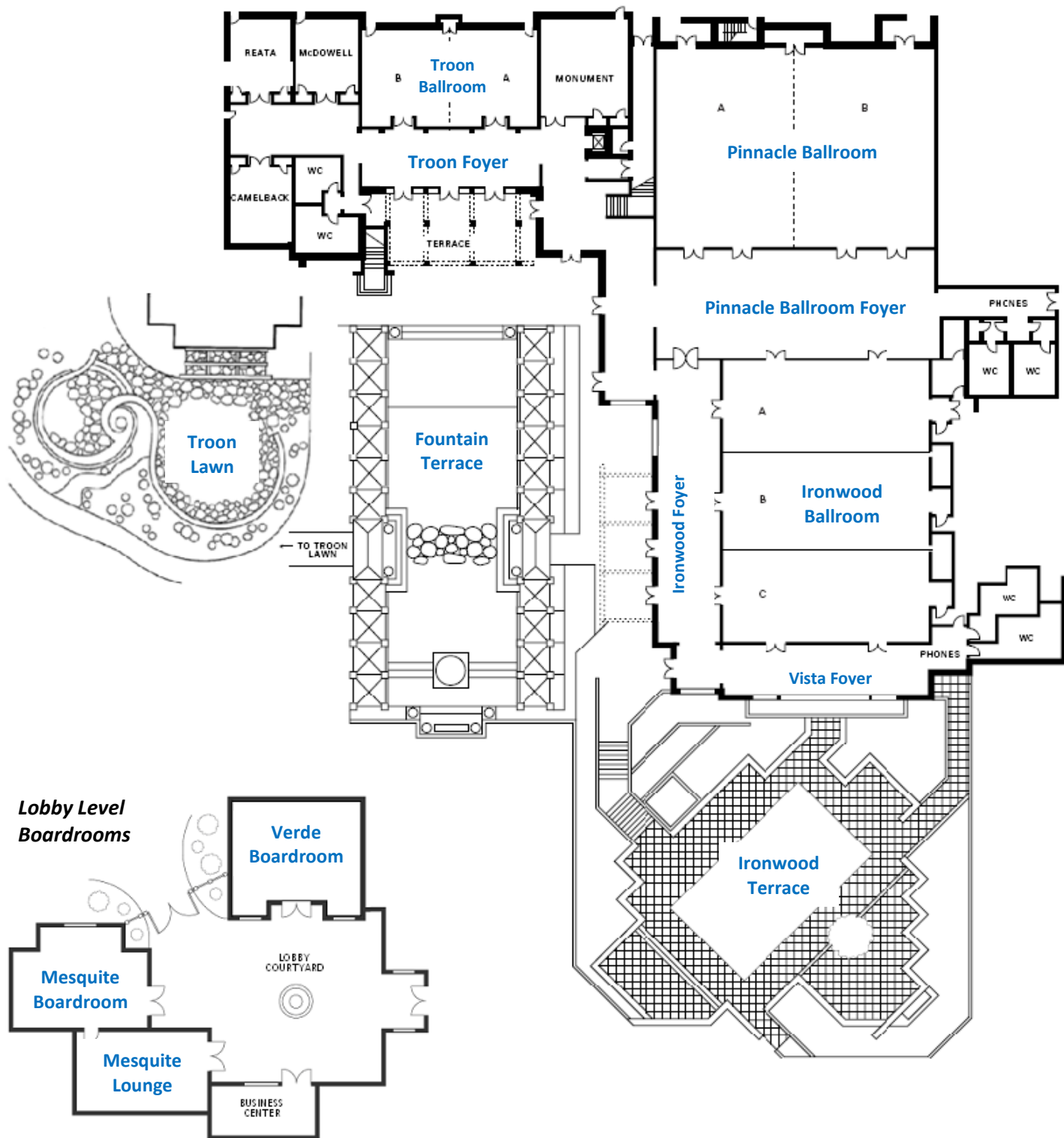

FOUR SEASONS
RESORT
SCOTTSDALE AT TROON NORTH

Ground Level Meeting & Event Space





FOUR SEASONS
RESORT
SCOTTSDALE AT TROON NORTH

Room	Dimensions (ft.)	Size		Ht.	Capacities						
		(sq. ft.)	(m ²)	(ft.)	Reception	Banquet	Theater	Classroom	Conference	Hollow Square	U-shape
Indoor Ground Level											
Ironwood Ballroom	64' x 88'	5,632	523	18'	400	360	450	340	76	96	90
Ironwood A, B, or C	28' x 64'	1,792	166	18'	125	120	130	100	36	36	30
Ironwood AB or BC	56' x 64'	3,584	333	18'	200	240	260	170	42	66	60
Ironwood Foyer	21' x 88'	1,848	172	12'	250	-	-	-	-	-	-
Vista Foyer	16' x 65'	1,040	97	12'	80	-	-	-	-	-	-
Pinnacle Ballroom	66' x 90'	5,940	552	21'	500	430	470	360	76	118	94
Pinnacle A or B	44' x 66'	2,970	270	21'	250	200	200	162	52	78	63
Pinnacle Foyer	33' x 90'	2,904	276	12'	250	-	-	-	-	-	-
Troon Ballroom	32' x 57'	1,824	169	9'	150	140	140	108	48	60	48
Troon A or B	28' x 32'	896	83	9'	75	50	50	48	22	30	24
Troon Foyer	20' x 58'	1,160	108	9'	100	-	-	-	-	-	-
Monument	25' x 30'	750	70	9'	60	50	40	30	22	30	24
McDowell	21' x 25'	525	49	9'	40	30	30	24	22	21	18
Reata	21' x 25'	525	49	9'	40	30	30	24	22	21	18
Camelback	21' x 24'	504	47	9'	40	30	30	24	22	18	18
Lobby Level Courtyard											
Verde Boardroom	18' x 25'	450	42	8'	-	12	-	-	12	-	-
Mesquite Lounge	13' x 24'	312	29	8'	20	-	-	-	-	-	-
Mesquite Boardroom	14' x 24'	336	31	8'	-	10	-	-	10	-	-
Ground Level Outdoor Event Lawns											
Fountain Terrace	40' x 97'	3,880	360	-	300	200	-	-	-	-	-
Fountain Terrace with Patio	Irregular	5,500	511	-	500	300	-	-	-	-	-
Ironwood Terrace	Irregular	4,600	427	-	500	360	-	-	-	-	-
Troon Lawn	Irregular	2,000	186	-	200	120	-	-	-	-	-